

## Map To: Beavercreek High School, Beavercreek, Ohio

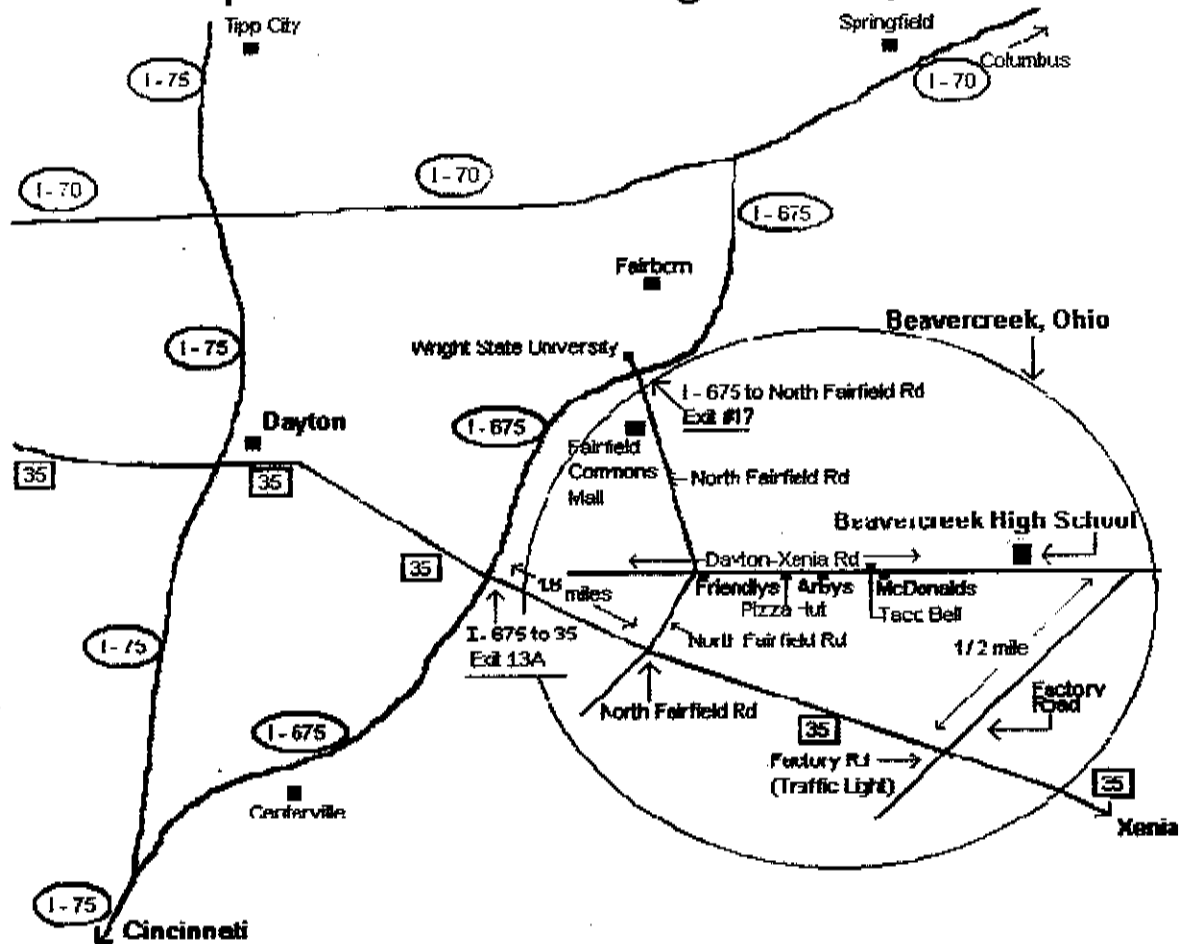

### From Cincinnati:

I-75 North to I-675 North. On I-675, Exit 13A to Highway 35 East, Xenia. On Highway 35 East, go approx 5 miles to the first traffic light turn left on Factory Rd. Next traffic light, (about 1/2 mile) turn left on Dayton-Xenia Rd. Beavercreek HS is about 1/4 mile on right.

### From Columbus:

I-70 West to I-675 South. On I-675, Exit 13A to Highway 35 East, Xenia. On Highway 35 East, go approx 5 miles to the first traffic light turn left on Factory Rd. Next traffic light, (about 1/2 mile) turn left on Dayton-Xenia Rd. Beavercreek HS is about 1/4 mile on right.

### From Indiana or North of Dayton:

Take I-75 South to Exit 52B, Highway 35 East to Xenia. On Highway 35 East, go about 10 miles to the first traffic light and turn left on Factory Rd. Next traffic light, (about 1/2 mile) turn left on Dayton-Xenia Rd. Beavercreek HS is about 1/4 mile on right.

### From Xenia:

Follow signs for Highway 35 West. As you approach Beavercreek, you will pass the Hidy Honda Dealership on right side of road. At the Next traffic light, turn right on Factory Rd. Next traffic light, (about 1/2 mile) turn left on Dayton-Xenia Rd. Beavercreek HS is 1/4 mile on right.



		7:30	8:00	8:30	9:00	9:30	10:00	10:30	11:00	11:30	12:00	12:30	13:00	13:30	14:00	14:30	15:00	15:30	16:00	16:30	17:00
1		0		B																	
2	Bellbrook High School Jazz Ensemble				P																
3	Lebanon Junior High School Jazz Band					P															
4	Lakota East 2 O'clock Freshman Jazz Band						P														
5	Lakota West 8 O'clock Jazz Band							P													
6	Kings Junior High School Jazz Band								P												
7	Lebanon High School Jazz Band									P											
8	Lakota East 12 O'clock Freshman Jazz Band										P										
9	Beavercreek High School Jazz Ensemble Two											P									
10	Lakota West 10 O'clock Jazz Band												P								
11	Kings High School Jazz Band													P							
12	Break														B						
13	Lancaster High School "Swinging Gales"															P					
14	Moeller Jazz Band																P				
15	Lakota West High School Jazz Ensemble																	P			
16	Troy High School Jazz Band																		P		
17	Beavercreek High School Jazz Ensemble One																			P	
18	Central State Jazz Band																				P
	Latin Percussion Masters Class											Rm 1003									
	Latin Rhythm Section Masters Class															Rm 1003					

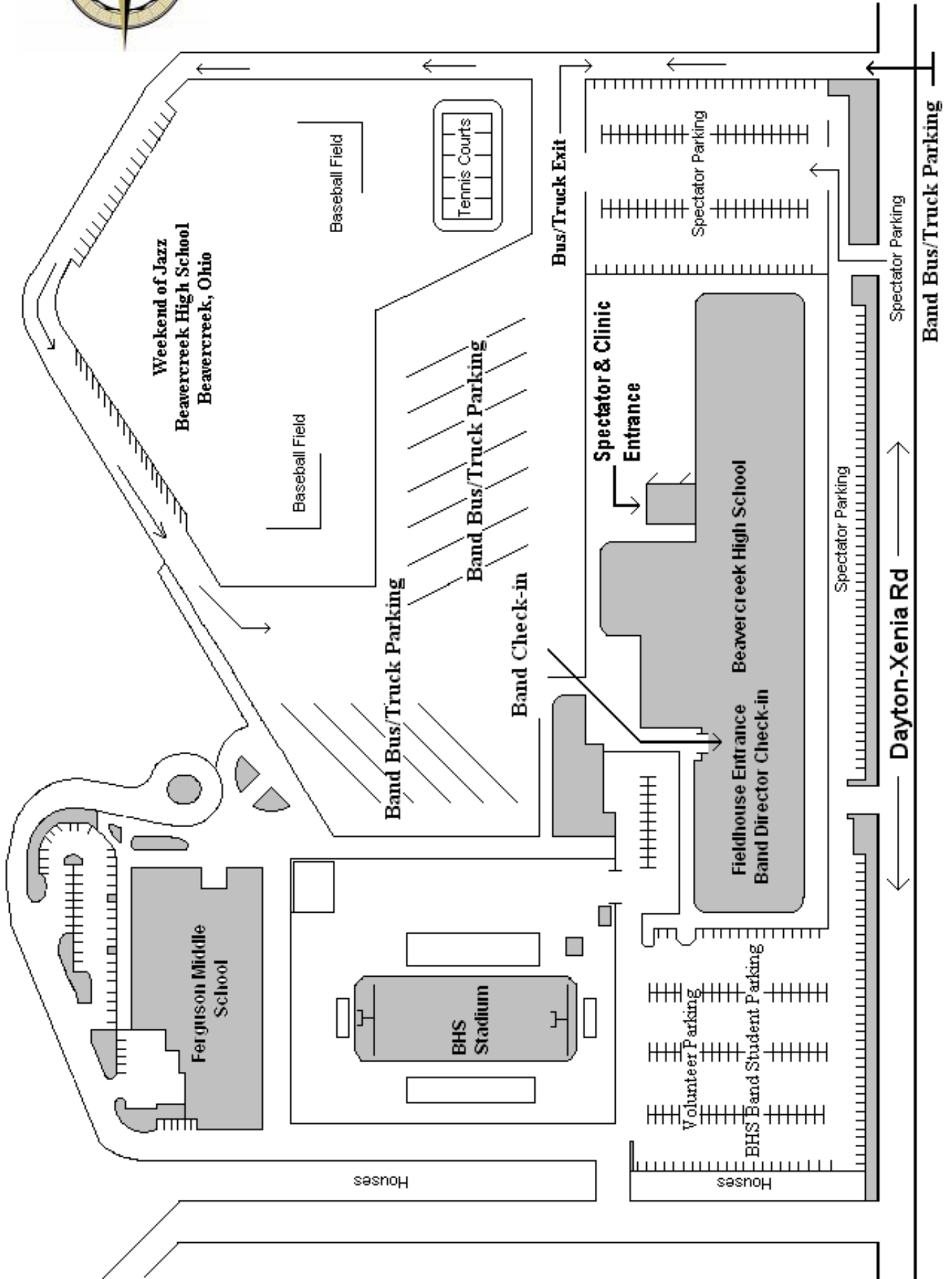

# Weekend of Jazz Beavercreek High School

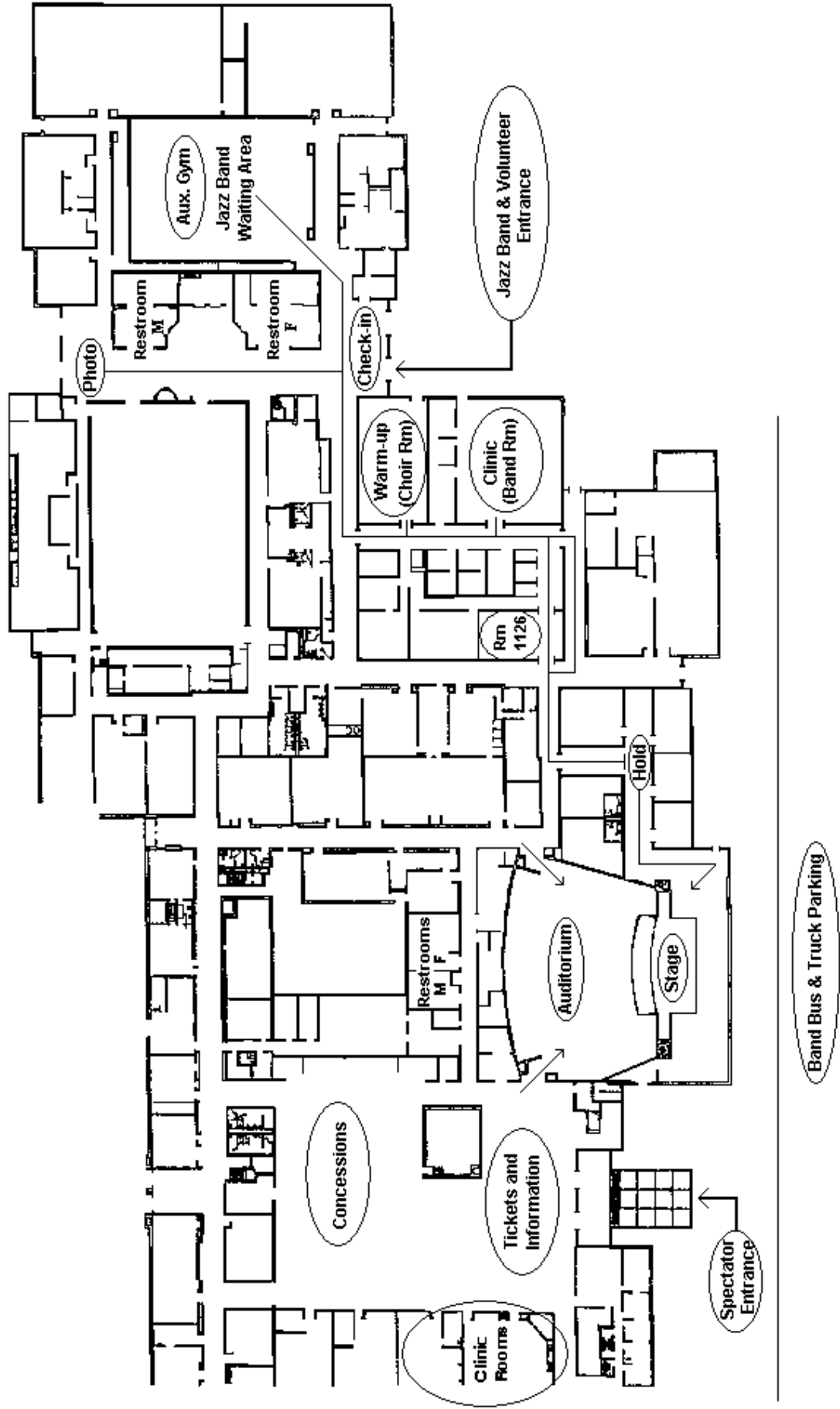

BHS Floorplan for Weekend of Jazz

**WEEKEND OF JAZZ CONCESSION MENU**  
**(Served in the High School Commons)**

Breakfast (8:00 am – 11:00 am)

<b>Cinnamon Roll</b>	<b>\$1.00</b>
<b>Muffin</b>	<b>\$1.00</b>
<b>Doughnut</b>	<b>\$ .75</b>
<b>Banana</b>	<b>\$ .50</b>

Lunch (11:00 am – 4:00 pm)

<b>Grilled Chicken Breast Sandwich</b>	<b>\$2.50</b>
<b>BBQ Pulled Pork Sandwich</b>	<b>\$2.50</b>
<b>Traveling Taco</b>	<b>\$1.50</b>
<b>Pizza Slice – cheese or pepperoni</b>	<b>\$2.00</b>
<b>Hot Dog</b>	<b>\$1.00</b>
<b>Breadsticks w/sauce</b>	<b>\$2.25</b>
<b>Soft Pretzel</b>	<b>\$1.00</b>
<b>Nachos with cheese</b>	<b>\$1.50</b>
<b>Nachos with cheese &amp; peppers</b>	<b>\$1.75</b>
<b>Chips</b>	<b>\$ .50</b>
<b>Applesauce</b>	<b>\$ .50</b>
<b>Cookies/Brownies</b>	<b>\$ .50</b>
<b>Candy</b>	<b>\$ .75</b>

Drinks (available all day)

<b>Coffee</b>	<b>\$1.00</b>
<b>Hot Chocolate</b>	<b>\$1.00</b>
<b>Sunny D</b>	<b>\$ .50</b>
<b>Pop – Pepsi products (bottle)</b>	<b>\$1.50</b>
<b>Gatorade (bottle)</b>	<b>\$1.50</b>
<b>Bottled Water</b>	<b>\$1.50</b>